

4A

Rear Brake Master Cylinder Disassembly and Assembly



Refer to [Rear Brake Master Cylinder Assembly Removal and Installation](#).

[Reference: Rear Brake Master Cylinder Assembly Components](#)

Disassembly

- 1) Disconnect the reservoir hose (1).
- 2) Remove the lock-nut (2).

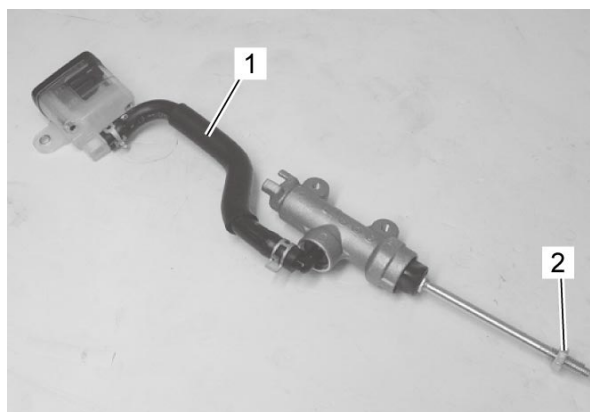

- 3) Remove the snap ring (1) with the special tool.

Special Tool

09900-06108

- 4) Remove the brake hose connector (2) and O-ring (3).

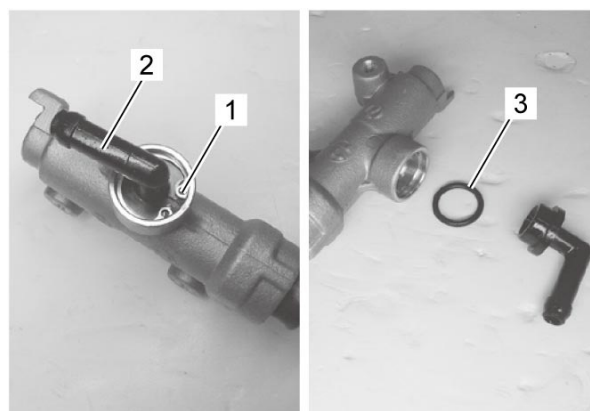

- 5) Pull out the dust boot (1) and remove the snap ring (2).

Special Tool

09900-06108

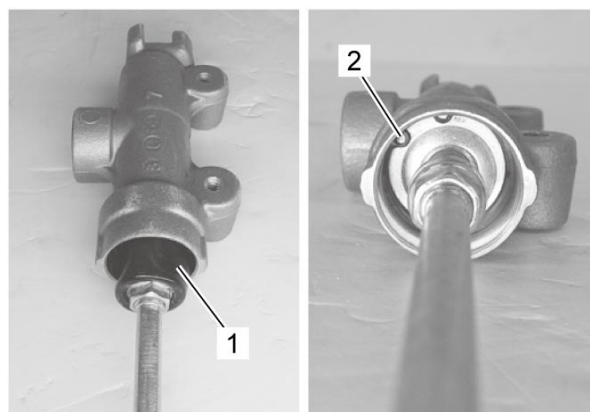

6) Remove the following parts from the master cylinder.

- Push rod (1)
- Piston/Secondary cup set (2)
- Primary cup (3)
- Return spring (4)

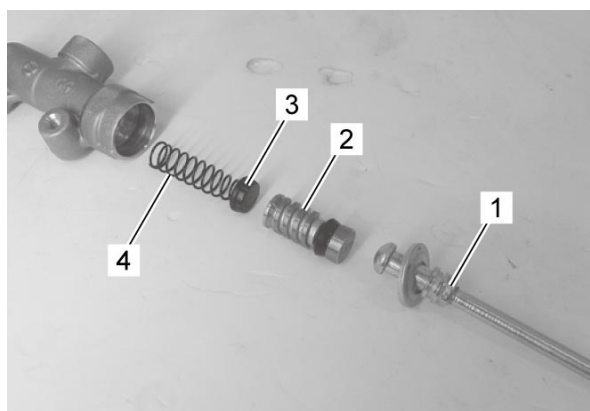

Assembly

[Reference: Rear Brake Master Cylinder Parts Inspection](#)

- 1)** Install the new primary cup (1) to the return spring (2).

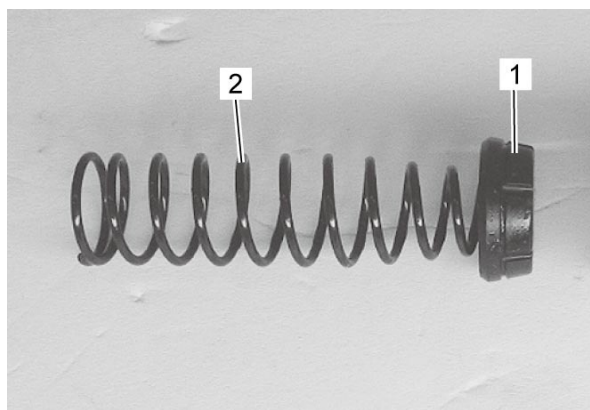

**NOTICE:**

- Wash the master cylinder components with new brake fluid before reassembly.
- Do not wipe the brake fluid off after washing the components.
- When washing the components, use the specified brake fluid. Never use different types of fluid or cleaning solvents such as gasoline, kerosine, etc.
- Apply brake fluid to the master cylinder bore and all of the master cylinder component to be inserted into the bore.

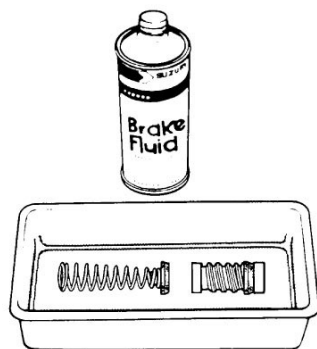
Brake fluid (DOT 4)

- 2) Install the primary cup/spring (1) and new secondary cup/piston (2) to the master cylinder.

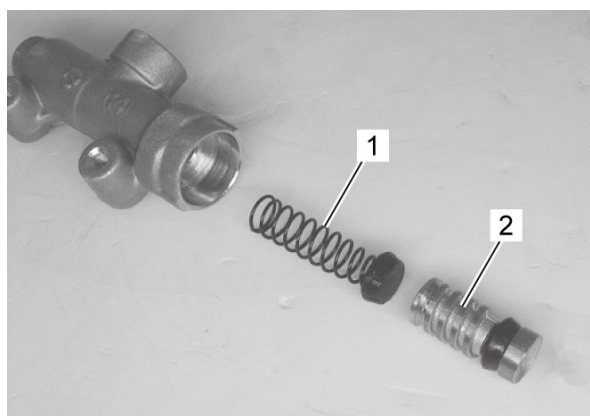

- 3) Apply grease to the push rod end.
"A": Grease 99000-25100 (SUZUKI SILICONE GREASE)
- 4) Install the push rod (1) to the master cylinder.
- 5) Install the new snap ring (2) with the special tool.

Special Tool**09900-06108**

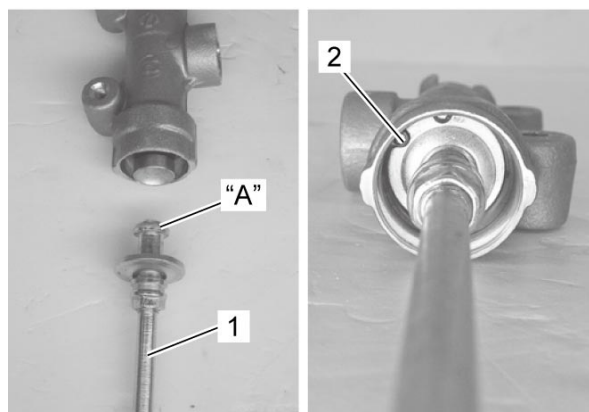

6) Apply grease to the lip of the dust boot (1).

"A": Grease 99000-25011 (SUZUKI SUPER GREASE A)

7) Set the dust boot (1) to the master cylinder securely.

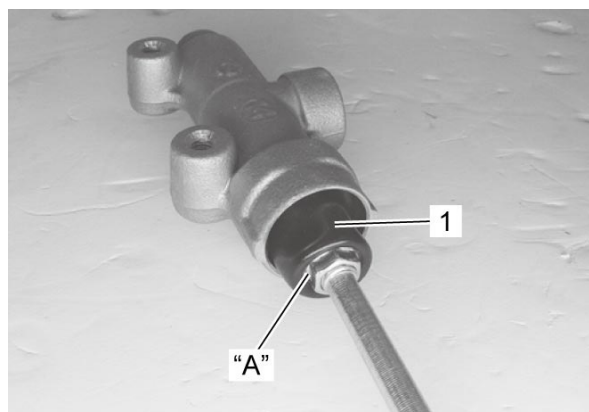

8) Install the new O-ring (1) to the brake hose connector (2).

9) Install the brake hose connector (2) to the master cylinder.

10) Install the new snap ring (3) with the special tool.

Special Tool

09900-06108

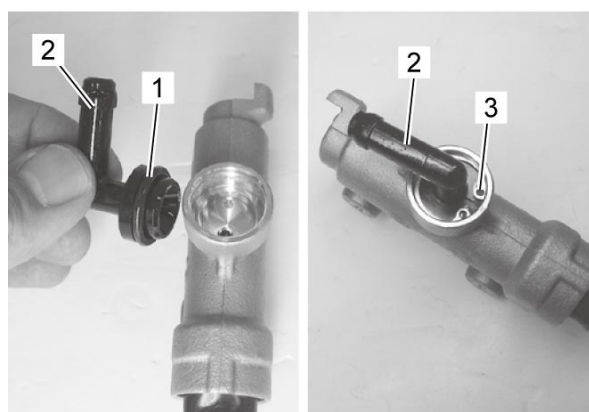



11) Install the lock-nut (1).

12) Connect the reservoir hose (2) and set the clips (3). Refer to [Rear Brake Hose Routing Diagram](#).

